

# EXP-155

REVISION: N  
ECO NO.: 3194  
BY: J. KUSBEL  
DATE: 3/07/2017

# COXREELS SLP & SMP MODELS

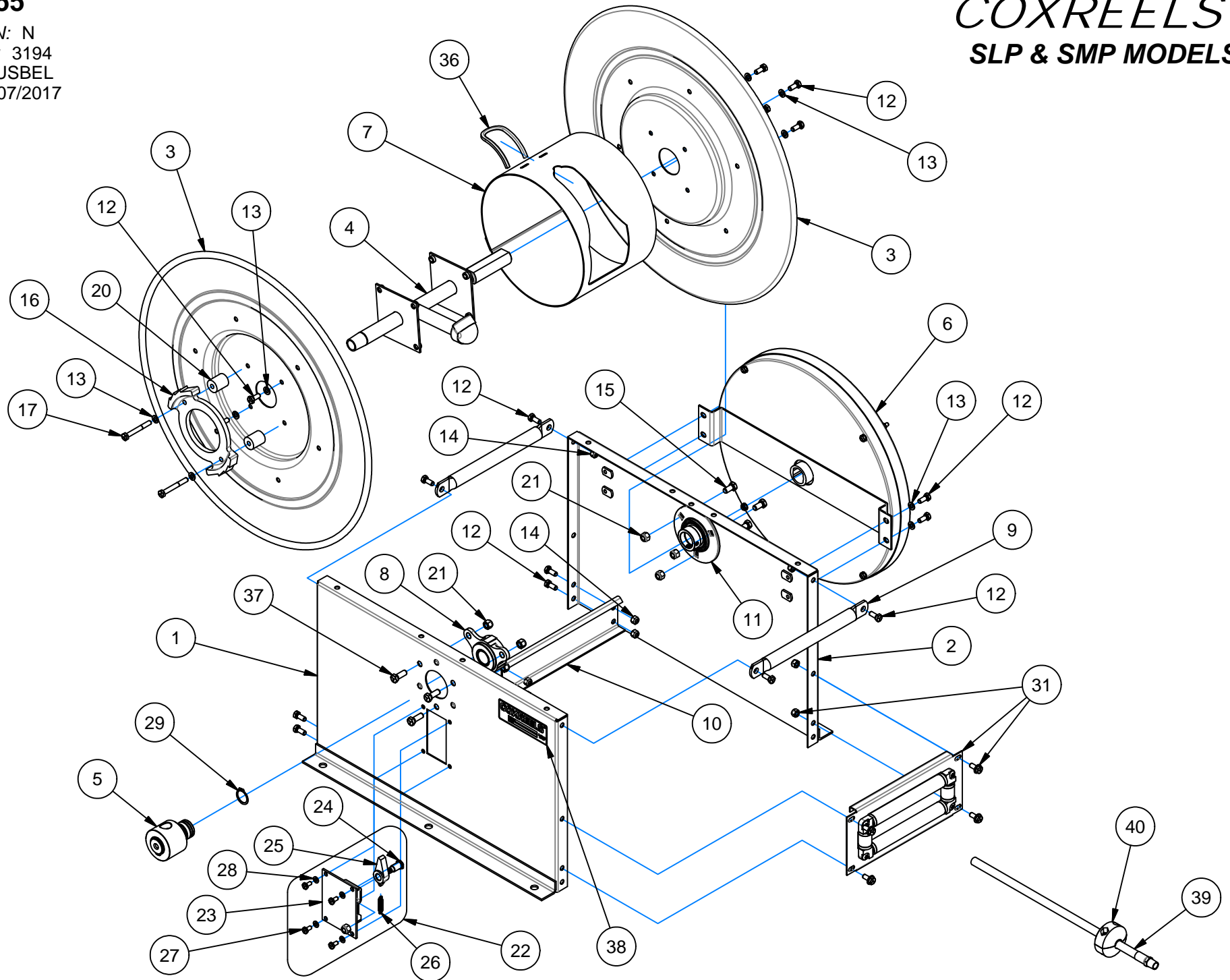

COMMON PARTS TO ALL SERIES SLP,SMP (-4XX,-5XX,-6XX) SERIES REELS

ITEM NO.	PART NO.	DESCRIPTION	QTY REQ'D
11	20300	ASSEMBLY, BEARING	1
12	312	BOLT, 5/16-18 X 3/4" LG	18
13	112	WASHER, LOCK, 5/16"	12
14	111	NUT, LOCK, 5/16-18	8
16	20194	RING, LOCKING	1
17	10218	BOLT, 5/16-18 X 2-1/2" LG	2
20	20780	SPACER	2
21	435	NUT, LOCK, 3/8-16	7
22	20000	ASSY, LOCKING BRACKET	1

ITEM NO.	PART NO.	DESCRIPTION	QTY REQ'D
23	639	BRACKET, LOCKING	1
24	1620	BOLT, SHOULDER	1
25	640	CAM, LOCKING	1
26	20019	SPRING, TENSION	1
27	113	BOLT, 1/4-20 X 1/2"	4
28	114	WASHER, LOCK, 1/2"	4
36	7460-14	TRIM, DRUM EDGE	1
37	20016	BOLT, 3/8-16 X 1"	3
38	10925-5	NAMEPLATE, PRODUCT	1

ITEM NUMBER

MODEL NO.	1	2	3	4	5	6	7	8	9	10	15	29	31	39 *	39 *	40 *
	PANEL	PANEL	DISC (2)	PLUMBING	SWIVEL	SPRING	DRUM	BEARING	BAR (2)	RAIL	BOLT (3)	R. RING	R. BRKT	STD HOSE	FUEL HOSE	B. STOP
SLP-4100	20224	20222	7799	7811	439	15240	7800-7.5	20276	20244-7.5	20385-7.5	436	153	8100-7.5	5154-100	-	131-4
SLP-550	20224	20222	7799	7812	426	20462	7800-7.5	20277	20244-7.5	20385-7.5	436	15015	8100-7.5	5155-50	5097-50	430
SLP-575	20230	20228	7603-1	7812	426	15243	7800-7.5	20277	20244-7.5	20385-7.5	436	15015	8100-7.5	5155-75	5097-75	430
SLP-5100	20230	20228	7603-1	7812	426	15233	7800-7.5	20277	20244-7.5	20385-7.5	436	15015	8100-7.5	5155-100	5097-100	430
SLP-625	20224	20222	7799	7813	15257-1	20429	7816-7.5	20996	20244-7.5	20385-7.5	436	15012	8101-7.5	5096-25	5092-25	20214
SLP-650	20230	20228	7603-1	7813	15257-1	20428	7816-7.5	20996	20244-7.5	20385-7.5	436	15012	8101-7.5	5096-50	5092-50	20214
SLP-675	20236	20234	7627-1	7813	15257-1	15236	7816-7.5	20996	20244-7.5	20385-7.5	436	15012	8101-7.5	5096-75	5092-75	20214

MODEL NO.	1	2	3	4	5	6	7	8	9	10	15	29	31	39*	39*	40*
	PANEL	PANEL	DISC	PLUMBING	SWIVEL	SPRING	DRUM	BEARING	BAR	RAIL	BOLT (3)	R. RING	R. BRKT	STD HOSE	FUEL HOSE	B. STOP
SMP-4100	20224	20222	7799	7811	439	15237	7800-7.5	20276	20244-7.5	20385-7.5	436	153	8100-7.5	5256-100	-	131-4
SMP-550	20224	20222	7799	7812	426	20428	7800-7.5	20277	20244-7.5	20385-7.5	436	15015	8100-7.5	5290-50	-	430
SMP-575	20230	20228	7603-1	7812	426	15236	7800-7.5	20277	20244-7.5	20385-7.5	436	15015	8100-7.5	5290-75	-	430
SMP-5100	20230	20228	7603-1	7812	426	15233	7800-7.5	20277	20244-7.5	20385-7.5	436	15015	8100-7.5	5290-100	-	430
SMPL-625	20224	20222	7799	7813	15257-1	15234	7816-7.5	20996	20244-7.5	20385-7.5	436	15012	8101-7.5	-	-	-
SMPL-650	20230	20228	7603-1	7813	15257-1	20431	7816-7.5	20996	20244-7.5	20385-7.5	436	15012	8101-7.5	-	-	-
SMPL-675	20236	20234	7627-1	7813	15257-1	15236	7816-7.5	20996	20244-7.5	20385-7.5	436	15012	8101-7.5	-	-	-

\* ON "LESS HOSE" MODELS (SLPL-/SMPL-) EXCLUDE ITEMS #39, AND #40.

NOTE: MODELS SUPPLIED WITH "FUEL" HOSE (SLPF-) USE ITEM #39 HOSE NUMBERS AS NOTED ABOVE.