



POWERFILL™

Cordless Loading Pumps



PROVEN QUALITY. LEADING TECHNOLOGY.

POWER FILL 3.5

CORDLESS LOADING PUMP

Introducing the industry's first cordless, powered loading pump designed to fill all automatic taping and finishing tools. PowerFill totally eliminates the need to manually pump. Now you can quickly fill with just the push of a button—eliminating daily fatigue and long-term injury.

NEVER HAND-PUMP AGAIN

BENEFITS YOU'LL APPRECIATE

- Single-button pumping eliminates fatigue and injury associated with manual pumping
- Hi-Rise Fill Tube* protects your back by eliminating bending
- Programmable to refill tools automatically with Precision Fill*
- Up to 3.5 gpm for lightning-fast filling—all day, every day
- Lightweight, compact design is perfect for any location, even tight scissor-lifts
- Quickly converts to right or left hand use for maximum flexibility
- Pumps up to 55 gallons on a single battery charge

FILLS IT ALL AND MORE

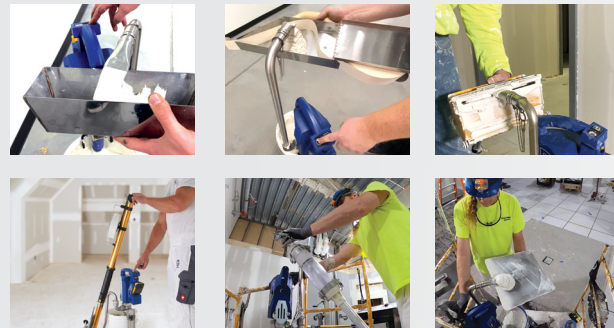

- Flat and Angle Boxes
- Compound Tube
- Hawk
- Automatic Taper
- Banjo
- Hopper Guns
- Nail Spotter
- Mud Tray
- Buckets and Hoppers



PowerFill 3.5 Pro Series
26B418

SAVE YOUR BACK WITH THE HI-RISE FILL PORT



- Ergonomic design eliminates bending—protecting your back
- Fully rotatable to position the outlet where you want it—such as over the bucket to catch drips

AUTOMATICALLY FILL WITH PRECISION FILL

- Fill your tools, pans or hawks to your preset level — with the push of a button
- Accuracy to within 1/4 oz for each fill—regardless of battery condition or pump speed
- Hands-free, continuous pumping mode is perfect to load or unload bulk containers and for easiest cleaning — just let it run!
- Increases overall job productivity so you can get more done!

PROGRAM IN 3 EASY STEPS

- 1 Press and hold **Program Button** until light flashes
- 2 Press **Pump Button** and fill to desired level
- 3 Press **Program Button** to save setting

INTRODUCING POWERSTROKE™ THE INDUSTRY'S LONGEST LIFE PUMP. PERIOD.



COMPACT DESIGN, NO-TOOLS CONVENIENCE

- Balanced, double-acting output for the smoothest material delivery and maximum efficiency
- Slim body design is 35% smaller diameter than manual pumps for easier cleaning and smaller “in-bucket” footprint

- ProConnect™ tool-less pump offers easy access to pump internal components
- 10 mesh filter offers 25% more filter area than manual pumps with no-tools removal



4X LIFE vs MANUAL PUMPS

- Anodized aluminum and stainless steel construction for unmatched life
- 4X life vs manual pumps



POWER FILL 3.5

CHANGING THE WAY YOU WORK FOREVER



HI-RISE FILL TUBE*

- Positions the outlet port higher to eliminate bending
- Tube rotates to position the outlet where you want—including above bucket to save space and contain drips
- Includes filler attachments for angle and flat boxes

PROCONNECT PUMP AND POWERHEAD

- No-tools pump and powerhead removal
- Allows removal of powerhead for storage
- Tear-down the pump in seconds for easy cleaning

POWERSTROKE PUMP

- Up to 3.5 gpm for the fastest tool fills
- The most durable loading pump available—virtually maintenance free
- Tool-less pump cylinder, inlet and filter removal for quick access and cleaning

ONE BUTTON PUMPING WITH AUTOMATIC FILL

- One button pumping totally eliminates fatigue and injury
- Automatic Precision-Fill Technology* allows automatic refill of tools to your preset level
- Hands-free Continuous Run* mode is perfect for transferring large quantities of material or self-cleaning

VARIABLE PUMP SPEED

- Adjustable fill speed—fast or slow, you decide

POWERED BY DEWALT

- Compatible with any 20V MAX Lithium-Ion DEWALT™ battery
- Pumps up to 55 gallon per charge for all-day use



ADJUSTABLE FOOT DESIGN

- No-tools adjustable to fit buckets up to 5 gallons
- Oversized foot bracket and stabilizer arm keeps pump in place on bucket
- Converts to right or left sided pump outlet in minutes

PATENT PENDING

JOBSITE TOUGH—INSIDE AND OUT

Cordless Powerhead with SmartControl™

- Integrated SmartControl offers single-button pumping
- Precision Fill Technology* automatically refills tools to your preset level—saving time
- ProControl™ Flow Adjustment lets you work at any speed
- Totally enclosed 20V Brushless DC motor requires no maintenance
- ProConnect™ tool-less removal for easy removal for storage or pump cleaning

WHERE SMART MEETS JOBSITE TOUGH

PATENT PENDING

FULLY-SEALED SILICONE SWITCHES

IMPACT-RESISTANT POLYPROPYLENE SHELL

ALL ALUMINUM CHASSIS

HARDENED STEEL GEARS



Remove the powerhead in seconds—*with no tools*



* Exclusive Pro Series Feature

CHOOSE THE RIGHT SERIES FOR YOUR BUSINESS

PowerFill 3.5 is designed to make your work easier, faster and more productive. Whether you are looking for the everyday reliability of our Standard Series, or the more ergonomic and productive Pro Series, Graco offers the ideal pump to meet your specific needs.



EVERYDAY RELIABILITY

Residential and Remodel Contractor

- Finishing periodically
- Jobs are often smaller
- Don't need extra features

STANDARD SERIES FEATURES:

- SmartControl™ with variable speed motor control
- PowerStroke Pump with 4X life
- ProConnect
- Horizontal Box Filler
- DEWALT 20V Lithium Ion Battery and Charger
- Adjustable Bucket Stabilizer

STANDARD SERIES



PRO SERIES

WORK SMARTER, FINISH FASTER

Large Residential and Commercial Contractor

- Everyday finishing
- Medium to large jobs
- Need features and to increase productivity

INCLUDES ALL THE STANDARD SERIES FEATURES

PLUS—

Hi-Rise Fill Tube

- Eliminates fatigue and injury associated with bending
- Rotates to position where you need it—perfect for tight areas such as scissor lifts and positioning outlet over the bucket

SmartControl Pro with Programmable Precision Fill

- Automatically fills tools to your preset level for increased productivity
- Continuous run mode for bulk transfer and easier hands-free cleaning



WHAT CONTRACTORS ARE SAYING



"When you're using half your energy to hand-pump, you're only left with half your energy to finish the wall. This takes care of that. All you do is hit a button. You can go twice as fast in a day with PowerFill."

Tony Morgan
32 year Drywall Finisher, Zintl Inc



"The worst part of hand pumping mud is the physical repetition. It really makes it hard on your shoulders and back. PowerFill makes my job physically easier by not having to manual pump. That is the bottom line"

Joel Bjorkquist
37 year Drywall Finisher, Prestige Drywall



"It pumps a lot faster than your typical hand pump and is less physical. After running tools all day, it's priceless"

Duane Bender
8 year Drywall Finisher, Swanson & Youngdale



Learn more at
graco.com/PowerFill

3 MODELS TO CHOOSE FROM



		POWERFILL 3.5 STANDARD SERIES	POWERFILL 3.5 PRO SERIES	POWERFILL 3.5 XL PRO SERIES
SPECIFICATIONS	Part Number	26B417	26B418	26B419
	Max GPM (lpm)	3.5 (13.2)	3.5 (13.2)	3.5 (13.2)
	Weight Lbs (Kg)	15 (6.8)	17 (7.7)	20 (9.1)
	Pump	PowerStroke	PowerStroke	PowerStroke
	Power/Battery	(1) DeWALT 20V MAX* COMPACT 2.0 ah Lithium-Ion Batteries and (1) Charger	(1) DeWALT 20V MAX* COMPACT 2.0 ah Lithium-Ion Batteries and (1) Charger	(1) DeWALT 20V MAX* COMPACT 2.0 ah Lithium-Ion Batteries and (1) Charger
	Pump Outlet	Fixed Horizontal w/Box Filler	Hi-Rise Fill Tube w/Box Filler	Hi-Rise Fill Tube w/Box Filler
	Precision Fill	No	Yes	Yes
	Inlet Filter	Tool-less, 10 Mesh (1)	Tool-less, 10 Mesh (1)	Tool-less, 10 Mesh (1)
	Adjustable Flow	Yes	Yes	Yes
	Fits Container	Adjustable up to 5 Gallon (7-15" Bucket Height Range)	Adjustable up to 5 Gallon (7-15" Bucket Height Range)	Adjustable up to 5 thru 30 Gallon (7-28" Bucket Range)

*With respect to 20v MAX, maximum initial battery voltage (measured without workload), is 20 volts. Nominal is 18 volts.



ACCESSORIES	PART #
14" Hi-Rise Fill Tube Kit (Contains: Hi-Rise Fill Tube w/Box Filler, Outlet Elbow)	18D159
23" Hi-Rise Fill Tube Kit (Contains: Hi-Rise Fill Tube w/Box Filler, Outlet Elbow)	18D160
Taper Gooseneck Fill Tube (5 Gallon) (Requires Outlet Elbow)	18D086
XL Taper Gooseneck (30 Gal) (Requires Outlet Elbow)	18D103
Outlet Elbow (For use with Hi-Rise Fill Tubes and Gooseneck)	18D163
14" Hi-Rise Fill Tube (Requires Outlet Elbow) (Contains: Hi-Rise Fill Tube w/Box Filler)	18D164
23" Hi-Rise Fill Tube (Requires Outlet Elbow) (Contains: Hi-Rise Fill Tube w/Box Filler)	18D165
30 Gallon XL Conversion Kit (Converts Pump to 30 Gallon XL) (Contains: Pump Rod with Upper Piston, XL Pump Cylinder Body, XL Adjustable Foot)	18D166
Cleaning Hose Flush Kit (Contains: Outlet Fitting, Hose, (2) Cleaning Balls)	18D167
Horizontal Fill Outlet (Contains: Horizontal Fill Outlet, Box Filler)	18D168
Box Filler (Fits Horizontal Fill Outlet or Hi-Rise Fill Tube)	18D169
Sponge Ball Clean Out Kit (QTY 5-1")	248515
Inlet Filter, 10 Mesh	18D170
DeWALT 20V MAX XR Lithium Ion Charger	17P475
DeWALT 20V MAX XR Lithium Ion Battery	17P474



WORK SMARTER WITH GRACO

Combine PowerFill with ProSurface™ Drywall Blades for Maximum Productivity

- The perfect combo for Level 5, Skim Coat and Drywall Joint finishing
- Increases productivity while reducing fatigue



ProSurface Drywall Kit (18C676) shown

For More information visit graco.com/ProSurface



Every Graco purchase comes with A+ Customer Service.

Questions?
Call (844) 241-9499

For more information visit graco.com

